

केन्द्रीय सरकारी कर्मचारी कल्याण आवास संगठन
CENTRAL GOVERNMENT EMPLOYEES
WELFARE HOUSING ORGANISATION

(Ministry of Housing & Urban Affairs, Govt. of India)
(An ISO 9001-2015 Organisation)

छठा तल, 'ए' खण्ड, जनपथ भवन,
जनपथ, नई दिल्ली-110 001
दूरभाष : 23739722 / 23717249 / 23355408
फैक्स : 23717250

6th Floor, 'A' Wing, Janpath Bhawan,
Janpath, New Delhi - 110 001
Phones : 23739722 / 23717249 / 23355408
Fax : 23717250
E-mail : cgewho@nic.in

No. A-504/1

9th July, 2024

NOTICE

Sub. : Participation in the Draw of Lot for allotment of Paid Car Parking under stilt in CGEWHO Greater Noida Ph-II Housing Scheme

Dear Sir/ Madam,

Subsequent to the manual draw of lot for allotment of specific Dwelling Units (DUs) including two Car Parkings, held on 6th July'2024 at Vigyan Bhawan, New Delhi, it is informed that further draw for allotment of additional Car Parking, under Stilt, has been scheduled on 15th July'2024 at 'Deputy Speaker Hall Annexe', Constitution Club of India, Rafi Marg, New Delhi – 110001 at 10.30 a.m. onwards.

2. Allottees, who have subscribed additional paid Parking, as per list attached, are hereby, invited to participate in the Draw. It is requested to arrive at the Venue by 10.00 A.M. with valid Government ID Proof for smooth entry. High tea will be served to the applicants. Please note that, Car Parking shall be outside the venue (service lane) at owner's risk.

(Roshan Kishore)

Asstt Director (Admn)

To :

- The Allottees – as per list attached

- Copy of Stilt parking drawing enclosed.

List of Allottees opted for paid Stilt Parking Greater Noida Ph-II Housing Scheme

S.No.	Regn_No	Name	Father/Spouse Name	DU No.	Block	Floor	Paid Parking Opt
1	GMD0206	Ramantaneyulu Gali	VENGALARAO	904	7	9	YES
2	GMD0117	Swati Singh	KUNWAR PAL SINGH	1002	7	10	YES
3	GMD0705	Subhash Chander	HARISH CHANDER	1403	12	13	YES
4	GMD0258	Kamlesh Kumar	MAMTA DEVI	704	8	7	YES
5	GMD0242	Anil Kumar	DEEP PRAKASH	203	11	2	YES
6	GMD0491	Anil Kumar Singh	SIA RAM	801	8	8	YES
7	GMD0738	Gulab singh	JAI LAL	602	7	6	YES
8	GMD0037	Mrutyunjay Behera	PRANAKRUSHNA BEHERA	701	7	7	YES
9	GMD0693	Rajeev Kumar	SUNITA DEVI	403	12	4	YES
10	GMD0403	Rajaretnam Chitra	RAMASAMY VARGHIS	904	10	9	YES
11	GMD0501	Krishna	SANJEEV KUMAR	604	7	6	YES
12	GMD0224	Jitender Singh	SUNDER SINGH	301	8	3	YES
13	GMD0059	Baboo Ram	HIMMAT SINGH	1402	7	13	YES
14	GMD0039	Kishore Pyarelal Govekar	PYARE LAL	404	8	4	YES
15	GMD0396	Ajoy Nandan	SHANTA NANDAN	1201	9	12	YES
16	GMD0052	Ashok Kumar	SHRI RAMCHANDRA RAM	1503	11	14	YES
17	GMD0041	Suman	NARESH KUMAR	803	12	8	YES
18	GMD0209	Meenakshi Kumar	RAMESH KUMAR	204	9	2	YES
19	GMD0072	Jay Prakash Singh	DEZY KUMARI	103	7	1	YES
20	GMD0111	Suresh Chandra	Late Sh. Phool Singh	301	7	3	YES
21	GMD0745	Kajor Mal Meena	JHUTHA LAL	504	10	5	YES
22	GMD0868	Yashoda	YUGAL KISHOR CHHANDWAL	101	9	1	YES
23	GMD0239	Somveer Singh	RAMPHAL SINGH	502	7	5	YES
24	GMD0417	Navin Kumar	LATE RAM BALAK SINGH	1102	12	11	YES
25	GMD0369	Pratiksha Saini	MANISH KUMAR DWIVEDI	1202	8	12	YES
26	GMD0283	Satya Shiva Munjal	ASHOK MUNJAL	1104	12	11	YES
27	GMD0873	Sonia Motwani	RAJESH MOTWANI	101	10	1	YES
28	GMD0582	Budhi Prakash Sharma	DEVI SHANKAR SHARMA	103	9	1	YES
29	GMD0216	Sanjay Kumar Saxena	RUCHI SAXENA	302	12	3	YES
30	GMD0387	Ravi Kumar	SATISH KUMAR	702	11	7	YES
31	GMD0309	Anil Mittal	LEENA MITTAL	304	8	3	YES
32	GMD0405	Manish gupta Gupta	LATE RAMESHWAR DAYAL GUPTA	1502	11	14	YES
33	GMD0140	Alok Avasthy	LT. P K AVASTHY	902	10	9	YES
34	GMD0825	Matcha ramu	NARASAM NAIDU MATCHA	204	10	2	YES
35	GMD0270	Seth pal Singh	RAM CHANDRA	1003	9	10	YES
36	GMD0087	Arun Kumar Sharma	S.K Sharma	804	11	8	YES

37	GMD0024	Jyoti Kumari	RAJINDER RAZDAN	202	9	2	YES
38	GMD0706	Satjeet Kaur	HARMEET SINGH	803	7	8	YES
39	GMD0034	Rita Allagh	PARVEEN KUMAR ALLAGH	1404	10	13	YES
40	GMD0007	Virendra Singh Khaira	BALBIR SINGH	601	12	6	YES
41	GMD0151	Pramod Chand	KAMLESHWER PRASAD	1101	11	11	YES
42	GMD0066	Rabindra Nath Jha	PARAMESHWAR JHA	1204	10	12	YES
43	GMD0055	Shambhu Nath Jha	SHIV DEO JHA	704	12	7	YES
44	GMD0010	Sushma Shukla	NISHI KANT SHUKLA	801	10	8	YES
45	GMD0324	Pramod Chandra Nawani	NARAIN DATT NAWANI	403	9	4	YES
46	GMD0213	Anita Gupta	HARISH KUMAR GUPTA	902	7	9	YES
47	GMD0095	Jagdish Chand Arora	LATE MATWALA RAM	404	12	4	YES
48	GMD0603	Sanjay Sharma	SHASHI PRAKASH SHARMA	901	9	9	YES
49	GMD0036	Reeti Saini	SATBIR SAJNI	504	9	5	YES
50	GMD0249	Ananya Ray Laksar	TIRTHANKAR SAHA	1204	11	12	YES
51	GMD0689	Krishna Murari Singh	MANORMA SINGH	104	12	1	YES
52	GMD0724	Dholuram Hari ram Nathani	LT HARI RAM DEEPCHAND NATHANI	1501	11	14	YES
53	GMD0346	Mithilesh Chandra Pandey	RAM KRIPAL PANDEY	1002	12	10	YES
54	GMD0248	Devendra Kumar Pandey	SUNITA PANDEY	601	11	6	YES
55	GMD0799	Dr chitra Gupta	SURESH CHAND GUPTA	903	9	9	YES
56	GMD0406	Anil Kumar Chopra	IRA CHOPRA	1503	7	14	YES
57	GMD0859	Rodas Singh	LT SH LAJJA SINGH	401	8	4	YES
58	GMD0332	Ajay Kumar Singh	RAJENDRA SINGH	1102	9	11	YES
59	GMD0415	Lalit Kumar Pande	LATE SH GIRIJA DUTT PANDE	1203	11	12	YES
60	GMD0747	Mahabir Dixit	SANTRAM DIXIT	1203	12	12	YES
61	GMD0164	Naresh Kumar Gupta	MADAN LAL GUPTA	401	9	4	YES
62	GMD0613	Mrudula Nair	NAIR.MRUDULA@GM AIL.COM	1204	8	12	YES
63	GMD0409	Om Prakash Upadhyay	BRAJ MOHAN UPADYAY	402	7	4	YES
64	GMD0664	Manoj Kumar Gupta	MADAN MAOHAN GUPTA	601	7	6	YES
65	GMD0392	Arvind Kumar Sharma	SH J B SHARMA	1103	7	11	YES
66	GMD0817	Sudhir Tripathi	LATE H C P TRIPATHI	1403	7	13	YES
67	GMD0734	Vishal Joshi	BANSHI DHAR JOSHI	404	9	4	YES
68	GMD0439	Ashwani Dua	DARSHAN LAL DUA	1001	11	10	YES
69	GMD0744	Shashi Kant Sharma	SAPNA SHARMA	201	7	2	YES

70	GMD0608	Bhanu Upadhyay	LATE SHRIDHAR UPADHYAY	304	9	3	YES
71	GMD0836	Vishakha Jamwal	JITENDER JAMWAL	303	12	3	YES
72	GMD0065	Vivek Jain	NEHA JAIN	303	7	3	YES
73	GMD0509	Anupam Dubey	PRAMOD KUMAR DUBEY	602	11	6	YES
74	GMD0661	Ashwani Kumar Sinha	KIRAN SINGH	903	12	9	YES
75	GMD0097	Arvind Kumar Shrivastwa	LT SH BINDHYACHAL PRASAD	1004	9	10	YES
76	GMD0300	Manju Lata	MAYARAM SHARMA	1103	10	11	YES
77	GMD0219	Subhash Chander	CHAMEL CHAND KATOCH	603	10	6	YES
78	GMD0568	Neeraj Kumar	DR NARENDRA KUMAR	604	8	6	YES
79	GMD0820	Vanik	NARENDER GOSAIN	704	7	7	YES
80	GMD0325	Dinesh Chandra Verma	SHARDA CHANDRA VERMA	901	10	9	YES
81	GMD0031	Ram Shakal	SRI FIRTOO RAM	1001	12	10	YES
82	GMD0240	Adarsh Markan	RAJIV KUMAR MARKAN	802	10	8	YES
83	GMD0540	Pranav Ganesh	RAS BIHARI KHARE	1501	8	14	YES
84	GMD0046	Anju Vij	KAMAL KUMAR VIJ	1504	12	14	YES
85	GMD0831	Shreya Rawat	RAJINDER SINGH	1003	12	10	YES
86	GMD0830	Manjit Singh Brar	GURBACHAN SINGH BRAR	401	7	4	YES
87	GMD0505	Yeshpal Singh	POONAM	1501	9	14	YES
88	GMD0772	Arvind Kumar	KAMLESH SHARMA	801	7	8	YES
89	GMD0575	Munmun Prasad Singh	LATE JWALA PRASAD SINGH	101	12	1	YES
90	GMD0179	Manish Kumar Vimal	LT. COL RETD. PHOOL SINGH VIMAL	801	12	8	YES
91	GMD0571	Virender Singh	RURIA RAM	1104	11	11	YES
92	GMD0758	Uma Shankar Vidyarthi	DHANUSHDHARI SHARMA	404	11	4	YES
93	GMD0469	Neel kamal Ghai	S P GHAI	1201	7	12	YES
94	GMD0202	Shambhu Kumar	SARYOD PRASAD	1404	7	13	YES
95	GMD0166	Rajnesh Jain	RAVINDER KUMAR	503	8	5	YES
96	GMD0197	Ankit Jena	PURNA CHANDRA JENA	503	11	5	YES
97	GMD0382	Harmohinder Pal Singh	SURINDER SINGH	401	12	4	YES
98	GMD0299	Udal Singh	GHASI RAM KATHERIA	204	11	2	YES
99	GMD0551	Jugal Kishore	BABU LAL	604	10	6	YES
100	GMD0482	Kwwal Krishan Uboveja	DHANPAT RAI UBOVEJA	202	12	2	YES
101	GMD0759	Shamsher Singh	BADAN SINGH	502	12	5	YES
102	GMD0605	Atul Yadav	JAY DAYAL SINGH YADAV	504	11	5	YES

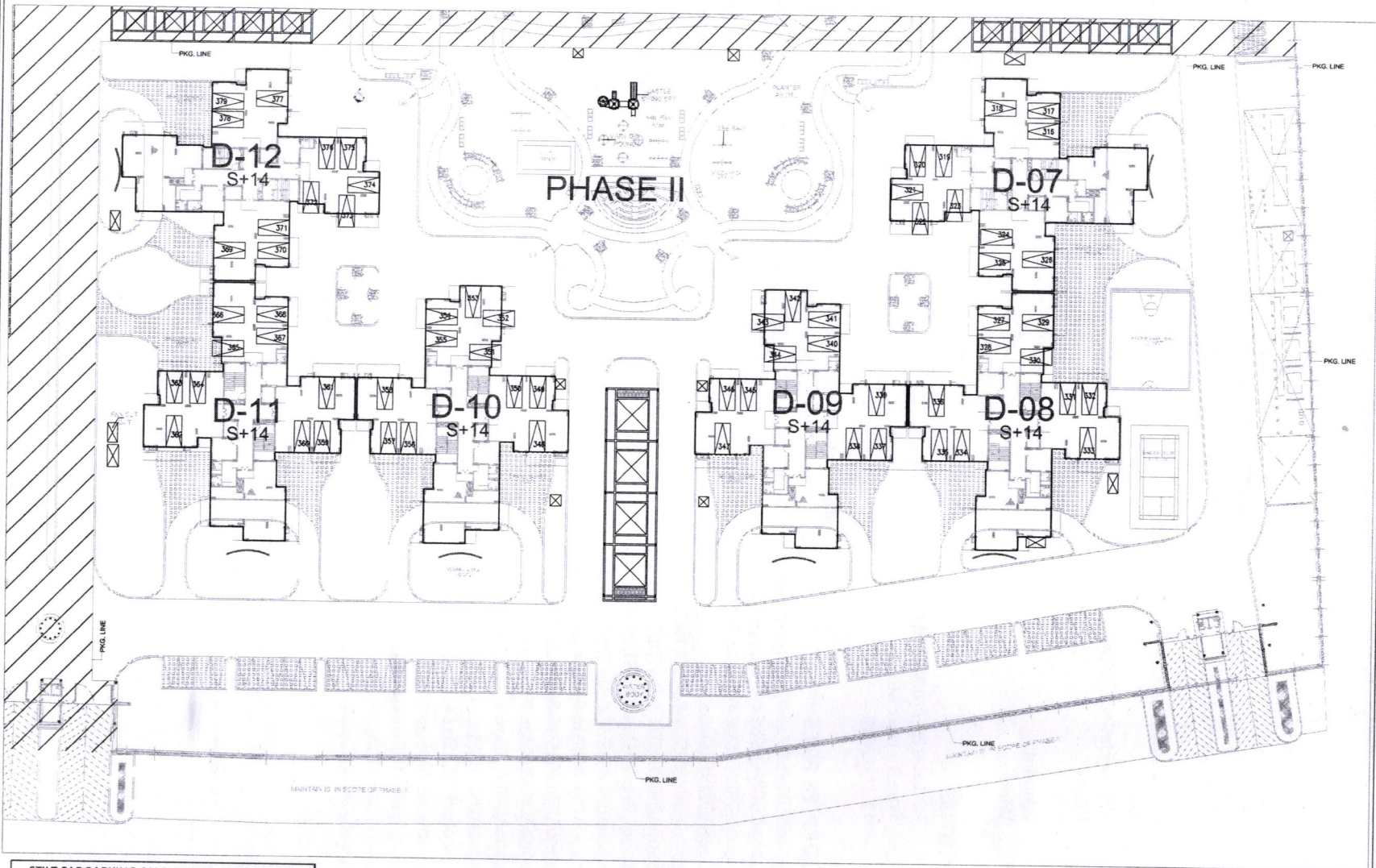

PRODUCED BY AN AUTODESK EDUCATIONAL PRODUCT

PRODUCED BY AN AUTODESK EDUCATIONAL PRODUCT

PROJECT NAME

PROPOSED GROUP HOUSING FOR CGEWHO AT PLOT NO. 07 SECTOR P-4, BUILDERS AREA GREATER NOIDA (U.P)

CLIENT NAME

CENTRAL GOVERNMENT EMPLOYEES WELFARE HOUSING ORGANISATION
6th Floor 'A', Wing, Janpath Bhawan, Janpath, New Delhi-110001
TEL: 011 - 2379722 / 23717249 / 23355408
FAX: 011 - 23717250
E-MAIL: cgewho@nic.in

SIGNATURE:

ARCHITECT & PMC

R T & Associates Pvt. Ltd.

ARCHITECTS, DESIGNERS & PROJECT MANAGEMENT
A-47 & 48, SECTOR - 07
NOIDA - 201301, UTTAR PRADESH
TEL: 0520-6485313, 6485314
FAX: 0520-6485313 E-MAIL: rtadesign@gmail.com

SIGNATURE:



WORKING DRAWING

PHASE-II

DRAWING TITLE:

LAYOUT PLAN

STILT PARKING

DRAWING NO. : CGEWHOC/07/02/07/01/01

DATE : 04/01/2011 DRAWN : R R K

SCALE : 1/4 S CHECKED : P S

03

STILT CAR PARKING CALCULATION FOR CGEWHO

DESCRIPTION	NO.	TOTAL NO. OF CAR EACH TOWER
TOWER-D07	316 TO 326	11
TOWER-D08	327 TO 336	10
TOWER-D09	337 TO 347	11
TOWER-D10	348 TO 358	11
TOWER-D11	359 TO 368	10
TOWER-D12	369 TO 379	11
TOTAL NOS. OF CAR		64